

*ScanSnap*

*ScanSnap s1100i*

The scanner you take to  
take care of business.

shaping tomorrow with you

FUJITSU

# Upgrade to business class.

Speedy "One Touch" scanning

The USB powered S1100i can scan a color document in less than 7.5 seconds\*

\*Single-side color letter document scanned at 300 dpi.

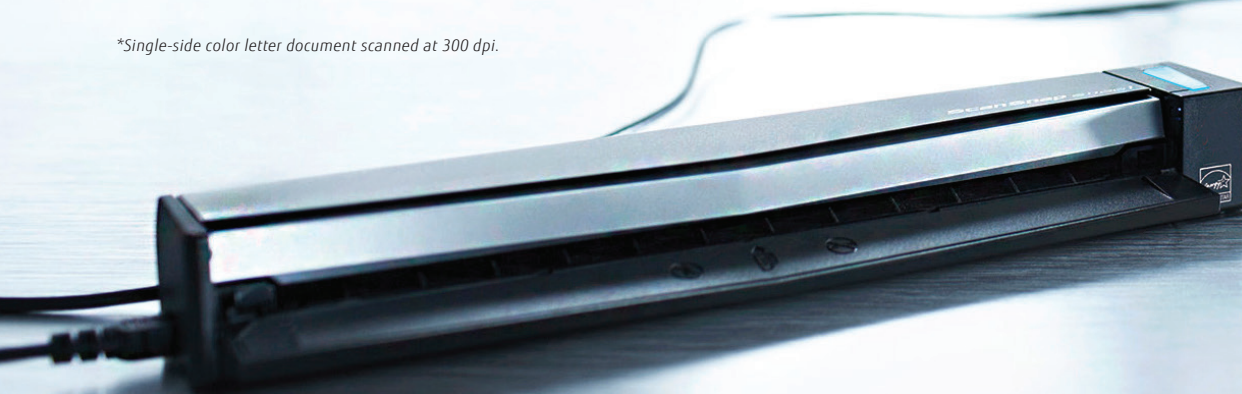

**Generate Microsoft® Word, Excel® and PowerPoint® files**  
ABBYY FineReader for ScanSnap® lets you scan and convert paper documents into Word, Excel and PowerPoint files.

Only Microsoft Word and Excel are available for Mac OS. Generated images and text may vary from the original.

## Scans to a greater range of mobile devices

Like all ScanSnap scanners, the S1100i supports wireless scanning to an iOS or Android® mobile device via the ScanSnap Connect mobile application\*.



\*Requires compatible PC or Mac computer and a Wi-Fi connection to mobile device. ScanSnap Connect Application is available as a free download from the Apple® App Store for iOS and Google® Play for Android.

## Intelligent automated features

Like all ScanSnap scanners the S1100i features a powerful set of automated image processing functions including auto color detection, crop and deskew, and blank page removal.

## Scans plastic cards and other various document types\*

In addition to standard paper types, the S1100i can scan plastic cards like driver's license or embossed cards.

\*Card type ISO 7810, ID-1 format = 86 x 54 mm (3.86 x 2.13 in.) (supports embossed cards)





## Easily synchronize documents to the cloud

S1100i provides users a convenient way to scan directly to your existing Evernote®, Dropbox, Google® Docs, SugarSync and salesforce® accounts.\*

## Scan there! ScanSnap Folder

Scan to virtually any application or web service that can open, insert or attach a PDF or JPEG file from your Microsoft® Windows® computer.



## Organize business cards

Use the included CardMinder software for Mac and PC to scan, store, and edit business card information and export data into applications like Address Book, Excel, and salesforce.



\*Wi-Fi connection required. Service fees may apply.

## New features for quick digitization



### Dual scan

Scan two small sized documents, such as business cards or receipts at the same time. Simply insert documents continuously to reduce your scanning time.

### Automatically stitch together a two-page spread

Even charts and diagrams larger than letter can be scanned. Just fold it in half, scan both sides and the S1100i will automatically stitch it back together.

## Two selectable paper paths

### Straight path

Most suitable for scanning postcards, business cards, plastic cards, and thick stock paper.

\*This applies to standard ISO 7810 ID-1 card types.

### U-turn path

Most suitable for scanning common office paper-work especially in a tight or cluttered environment.

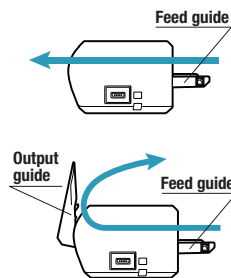

Scan to Picture Folder	ScanSnap Organizer	Scan to CardMinder	Scan to Folder	Scan to E-mail	Scan to Print
Scan to Mobile	Scan to Dropbox	Scan to Evernote (Doc...)	Scan to Evernote (Note)	Scan to Google Docs(TM)	Scan to Salesforce Cha...
Scan to SugarSync	ABBYY Scan to Word	ABBYY Scan to Excel(R)	ABBYY Scan to PowerPoint(R)	<i>*Quick Menu for Windows shown</i>	

## Fast and flexible Quick Menu

The Quick Menu for PC and Mac automatically pops up after scanning to provide you a variety of ways to be immediately productive with your scans. It can be customized to display just your favorites, present a recommendation, and even display custom profiles.

## Continuous Document Feeding (CDF)

The Continuous Document Feeding function allows you to insert pages one after another by detecting when a sheet enters and exits.



Set your document face-up into the S1100i and push the Scan button.



The S1100i proceeds to scan the front side.



The page exits from the top of the scanner when paper path is set to U-turn.



Re-insert the page without pressing the Scan button to scan the other side.



After you finish scanning, press the Scan button to save file.

## ■General Specifications

Description			ScanSnap S1100i / PA03610-B102
Scanner type			CDF (Continuous Document Feeding), Simplex sheetfeed two-way paper path (Straight path, U-turn path)
Scanning modes			Color, grayscale, monochrome, automatic (color / grayscale / monochrome detection)
Image sensor			CIS (Contact Image Sensor) x 1
Light source			3 Color LED (Red / Green / Blue)
Optical resolution			600 dpi
Scanning speed (Letter portrait) ★1	USB bus powered	Auto mode (default) ★2	7.5 seconds / page
		Normal mode (150 dpi)	
		Better mode (200 dpi)	
		Best mode (300 dpi)	
		Excellent mode (600 dpi)	35 seconds / page
Document size		Normal mode	A4, A5, A6, B5, B6, Business card, Postcard, Letter, Legal and Custom sizes (Max: 216 x 360 mm (8.5 x 14.17 in.), Min: 25.4 x 25.4 mm (1 x 1 in.)) / Automatically recognizes document size
		Normal mode with Carrier Sheet	Use of a carrier sheet permits the scanning of A3, B4, 11 x 17 in. and photographs as well as the document sizes that are listed above
		Long paper scanning ★3	Max: 216 x 863 mm (8.5 x 34 in.) (300 dpi or less)
Paper weight (Thickness)			● 52 to 209 g/m <sup>2</sup> , or 14 to 56 lb (Straight path) ● 52 to 80 g/m <sup>2</sup> , or 14 to 20 lb (U-turn path) ● Card: Portrait or Landscape (Straight Path) Non-embossed: 0.76 mm or less Embossed: 0.76 + 0.48 mm (ISO7810 Conforming)
Paper setting			Front-side up
Interface ★4			USB 2.0 (USB 1.1 compatible)
Power requirement			5 V / 0.5 A ( x 1port)
Power consumption			During operation: 2.5 W or less, During sleep mode: 1W or less During Auto Standby (OFF) mode: Less than 0.5 W
Operation environment			Temperature: 5 to 35° C (41 to 95° F) Relative humidity: 20 to 80% (Non-condensing)
Dimensions (W x D x H) ★5			273 x 47.5 x 34 mm (10.74 x 1.87 x 1.33 in.)
Device weight			350 g (0.77 lb)
Environmental compliance			ENERGY STAR® / RoHS
Multifeed detection			None
Driver			ScanSnap specific driver ● Windows®: Does not support TWAIN / ISIS™ ● Mac OS: Does not support TWAIN

<sup>★1</sup> Scanning speeds may vary due to the system environment used, Scanning speed means the time from "Start feeding document" to "Finish output document" after pre-pick and pushing Scan button. In case of "From pushing Scan button", Warm-up time is added. ● Warm-up time: Less than 2 seconds from ready status (Less than 3 seconds after opening chute cover) <sup>★2</sup> Documents measuring approximately 148 mm in length or less are scanned in "Best mode", while other documents are scanned in "Better mode". <sup>★3</sup> The S1100i is capable of scanning documents that exceed letter size in length. This function is available for all modes except "Excellent mode". <sup>★4</sup> Computer with USB 3.0 will work as USB 2.0 guaranteed only with USB cable provided with product. <sup>★5</sup> When the paper output guide is in the folded position

## ■Software

	Windows <sup>*</sup>	Mac OS
Driver <sup>★1</sup>	ScanSnap Manager V6.3	ScanSnap Manager V6.3
	ScanSnap Organizer V5.2	ScanSnap Organizer V1.1
Applications	CardMinder™ V5.2	CardMinder™ V5.2
	ABBYY FineReader for ScanSnap 5.0	ABBYY FineReader for ScanSnap 5.0
	Scan to Microsoft SharePoint 3.4	-

<sup>★1</sup> TWAIN or ISIS™ applications cannot be used directly.

## ■Included items

● Safety Precautions ● Setup DVD-ROM ● USB cable (2.0 m)
--

This scanner is designed to digitize materials that can be reproduced lawfully, in accordance with applicable copyright regulations and other laws. ScanSnap users are responsible for how they use this scanner. It is imperative that ScanSnap users comply with all applicable local rules and laws, including, without limitation, copyright laws when using this scanner.

★ ABBYY and FineReader are trademarks of ABBYY Software, Ltd., which may be registered in some jurisdictions. ABBYY FineReader Engine ©2011 ABBYY, OCR by ABBYY. ★ Adobe, Acrobat is either registered trademark or trademark of Adobe Systems Incorporated in the United States and/or other countries. ★ Evernote is a registered trademark or trademark of Evernote Corporation. ★ Google, Google Docs, Android and Google Play are registered trademarks or trademarks of Google Inc. ★ Intel, Pentium, and Intel Core are registered trademarks or trademarks of Intel Corporation in the United States and other countries. ★ ISIS is a registered trademark of EMC Corporation in the United States. ★ Mac, Mac OS, OS X, iPad and iPhone are trademarks of Apple Inc. ★ Microsoft, Windows, Windows Vista, Excel, PowerPoint, SharePoint and Internet Explorer are either registered trademarks or trademarks of Microsoft Corporation in the United States and other countries. ★ Word is the product of Microsoft Corporation in the United States. ★ Salesforce and Salesforce CRM are registered trademarks or trademarks of salesforce.com, inc. in the United States and other countries. ★ ScanSnap, ScanSnap logo, ScanSnap Manager, ScanSnap Organizer, CardMinder and Rack2-File are registered trademarks or trademarks of PFI LIMITED in Japan. ★ Wi-Fi and Wi-Fi Protected Setup are trademarks of Wi-Fi Alliance. ★ Other company names and product names are the registered trademarks or trademarks of the respective companies. ★ ENERGY STAR is a trademark or registered trademark of the U.S. Environmental Protection Agency.

Visit the ScanSnap homepage for additional information: <http://www.scansnap.ca>

▲ Safety Precautions	
Be sure to carefully read all safety precautions prior to using this product and use this device as instructed.	Do not place this device in wet or oily areas; or subject it to environments high in dust or moisture. Doing so may result in electrical shock, fire, or product damage.

**Fujitsu Canada, Inc**  
155 University Avenue, Suite 1600  
Toronto, Ontario M5H 3B7



## ■ScanSnap S1100i System Requirements

### ●Windows®

Compatible operating systems		Windows 8 / 8.1 (32-bit / 64-bit)	Windows 7 (32-bit / 64-bit) *1	Windows Vista® (32-bit / 64-bit) *2
Driver / Applications *3	ScanSnap Manager V6.3	Supported	Supported	Supported
	ScanSnap Organizer V5.2	Supported	Supported	Supported
	CardMinder™ V5.2	Supported	Supported	Supported
	ABBYY FineReader for ScanSnap™ 5.0	Supported	Supported	Supported
	Scan to Microsoft® SharePoint® 3.4	Supported	Supported	Supported
Hardware requirements *4	CPU *5	Intel® Core™ i5 2.5 GHz or higher		
	Memory capacity *5	4 GB or more		
	Display	1,024 x 768 pixels or higher	800 x 600 pixels or higher	
	Disk capacity *6	2,690 MB or more of free hard disk space		
	DVD-ROM drive	Required for installation		
	USB port *5 *7	USB2.0 / USB1.1		

<sup>★1</sup> Service Pack 1 or later required. <sup>★2</sup> Service Pack 2 or later required. <sup>★3</sup> For the latest support information, visit the ScanSnap homepage. <sup>★4</sup> The ScanSnap device may not work if the connected computer does not meet this requirement. <sup>★5</sup> Scanning speeds may drop if recommended CPU, memory capacity and USB requirements are not met. <sup>★6</sup> Microsoft .NET Framework 3.5 SP1 will be installed (requires 500 MB of disk space) together with either ScanSnap Manager or ScanSnap Organizer for systems that do not have .NET Framework 3.5 SP1 installed. <sup>★7</sup> When the ScanSnap is connected to a USB 3.0 port, the port operates as a USB 2.0 port. ★ System requirements may change depending on the duration of support and the support policy of the companies that make the software listed in the table above.

### ●Mac OS

Compatible operating systems		OS X v10.9 <sup>★1</sup>	OS X v10.8 <sup>★2</sup>	Mac OS X v10.7 <sup>★3</sup>
Driver / Applications <sup>★3</sup>	ScanSnap Manager V6.3	Supported	Supported	Supported
	ScanSnap Organizer V1.1	Supported	Supported	Supported
	CardMinder™ V5.2	Supported	Supported	Supported
	ABBYY FineReader for ScanSnap 5.0	Supported	Supported	Supported
Hardware requirements <sup>★5</sup>	CPU <sup>★6</sup>	Intel® Core™ i5 2.5 GHz or higher		
	Memory capacity <sup>★6</sup>	4 GB or more		
	Display	1,024 x 768 pixels or higher		
	Disk capacity	1,930 MB or more of free hard disk space		
	DVD-ROM drive	Required for installation		
	USB port <sup>★6</sup> <sup>★7</sup>	USB2.0 / USB1.1		

<sup>★1</sup> OS X v10.9.1 or later recommended. <sup>★2</sup> OS X v10.8.5 recommended. <sup>★3</sup> Mac OS X v10.7.5 recommended. <sup>★4</sup> For the latest support information, visit the ScanSnap homepage. <sup>★5</sup> The ScanSnap device may not work if the connected computer does not meet this requirement. <sup>★6</sup> Scanning speeds may drop if recommended CPU, memory capacity and USB <sup>★7</sup> When the ScanSnap is connected to a USB 3.0 port, the port operates as a USB 2.0 port. ★ System requirements may change depending on the duration of support and the support policy of the companies that make the software listed in the table above.

## ■Options

Description	Part number	Remarks
ScanSnap S1100 Case <sup>★1</sup>	PA03610-0001	Intended for ScanSnap S1100i and included items
ScanSnap Carrier Sheets <sup>★2</sup>	PA03360-0013	5 Carrier Sheets Intended for ScanSnap iX500, iX100, S1500, S1500M, S1100i, S1100, S510, S510M

<sup>★1</sup> This product has been especially designed for storing and carrying ScanSnap S1100i. Please note that this product is not guaranteed to withstand damage by excessive shock or external pressure. <sup>★2</sup> Although ScanSnap Carrier Sheets have a listed lifespan of 500 scans, the lifespan may vary with usage. ScanSnap Carrier sheets are intended to scan paper documents with weights of 127 g/m<sup>2</sup> or less. They also support the scanning of folded documents that are as large as 216 x 297 mm.

## ■Consumables

Description	Part number	Remarks
Cleaner F1	PA03950-0352	100 ml bottle Used to clean rollers

**POWERED BY**  
**ABBYY**  
**FineReader**  
**OCR**

**ABBYY**  
**FineReader**  
**OCR**

ABBYY™ FineReader™ Engine ©2011 ABBYY, OCR by ABBYY  
ABBYY and FineReader are trademarks of ABBYY.

ENERGY STAR

PFI LIMITED, a Fujitsu company, has determined that this product meets the ENERGY STAR guidelines for energy efficiency. ENERGY STAR is a registered trademark of the United States.

Mac

Universal